	<b>SPARTANBURG STAINLESS PRODUCTS</b>  <b>PRESS LINE SPECIFICATION</b> <b>PRESS 2700</b> (98" x 61" 550 Ton Single – Action)	Document No.: S02.?  Issue Date: 2/22/07 Revision:3 Page 2 of 11
---	--	---

**PRESS INFORMATION**

	Inner	Outer
Work Capacity .....	550 Tons	N/A
Ram Size L/R – F/B .....	98" – 61"	N/A
Ram Spacer Thickness .....	None	N/A
Length of Stroke .....	9.84"	N/A
Slide Adjustment .....	9.84"	N/A
Shut Height From Lower Bolster S.D.A.U. (Including QDC Plate) .....	29.00"	N/A
Target Die Height .....	22"	N/A
Bolster Size L/R – F/B .....	98" – 61"	
Lower Bolster Thickness .....	4.87"	
Rolling Bolster .....	None	
Carriage Thickness .....	N/A	
Bolster Spacer .....	None	
Bolster Spacer Thickness .....	N/A	
Positive Knockout .....	None	
Quick Die Change Sub-Plates .....	Yes	
QDC Plate Thickness .....	3"	
Cushions (Number) .....	None	
Tons Each .....	N/A	
Tons Total .....	N/A	
Stroke .....	N/A	
Quantity @ Size L/R – F/B .....	N/A	
Distance From Bolster To Drip Pots .....	N/A	
Distance Between Drip Pots L/R .....	116.14"	
Strokes Per Minute .....	25-50	

	<b>SPARTANBURG STAINLESS PRODUCTS</b>  <b>PRESS LINE SPECIFICATION</b> <b>PRESS 2700</b> (98" x 61" 550 Ton Single – Action)	Document No.: S02.?  Issue Date: 2/22/07 Revision:3 Page 3 of 11
---	--	---

**PRESS INFORMATION (Metric)**

	Inner	Outer
Work Capacity .....	499 MT	N/A
Ram Size L/R – F/B .....	2489mm – 1549mm	N/A
Ram Spacer Thickness .....	None	N/A
Length of Stroke .....	250mm	N/A
Slide Adjustment .....	250mm	N/A
Shut Height From Lower Bolster S.D.A.U. (Including QDC Plate) .....	736.6mm	N/A
Target Die Height .....	559mm	N/A
Bolster Size L/R – F/B .....	2489mm – 1549mm	
Lower Bolster Thickness .....	123.70mm	
Rolling Bolster .....	None	
Carriage Thickness .....	N/A	
Bolster Spacer .....	None	
Bolster Spacer Thickness .....	N/A	
Positive Knockout .....	None	
Quick Die Change Sub-Plates .....	Yes	
QDC Plate Thickness .....	76.20mm	
Cushions (Number) .....	None	
Tons Each .....	N/A	
Tons Total .....	N/A	
Stroke .....	N/A	
Quantity @ Size L/R – F/B .....	N/A	
Distance From Bolster To Drip Pots .....	N/A	
Distance Between Drip Pots L/R .....	2950mm	
Strokes Per Minute .....	25-50	

	<p align="center">SPARTANBURG STAINLESS PRODUCTS</p> <p align="center">PRESS LINE SPECIFICATION  <b>PRESS 2700</b>  (98" x 61" 550 Ton Single – Action)</p>	<p align="center">Document No.: S02.?</p> <p align="center">Issue Date: 2/22/07  Revision:3  Page 4 of 11</p>
---	---	---

**AUTOMATION DEVICES USED (Continued)**

**COIL LINE**

Coil Feeder	.....	Yes
Material Thickness vs. Material Width	.....	0.219" @ 30"
Material Thickness vs. Material Width		0.25" @ 24"
Feed Pitch Peek Velocity	.....	100 ft. / Min.
Coil Inner Diameter (Max. & Min.)	.....	20.5" & 15.5"
Coil Outer Diameter (Max.)	.....	72"
Material Feed Height (From Top Of Bolster)	.....	15"
Max. Coil Weight	.....	10 Tons / Coil
Roll Lift	.....	Yes
Uncoil	.....	Over Top

 <p><b>Spartanburg</b> STAINLESS PRODUCTS INC.</p>	<p>SPARTANBURG STAINLESS PRODUCTS</p> <p>PRESS LINE SPECIFICATION <b>PRESS 2700</b> (98" x 61" 550 Ton Single – Action)</p>	<p>Document No.: S02.?</p> <p>Issue Date: 2/22/07 Revision:3 Page 5 of 11</p>
---	---	---

### **PRESS INFORMATION GENERAL**

Comments:

1) ?

2) ?



SPARTANBURG STAINLESS PRODUCTS

PRESS LINE SPECIFICATION  
**PRESS 2700**  
(98" x 61" 550 Ton Single – Action)

Document No.:  
S02.?

Issue Date: 2/22/07  
Revision:3  
Page 6 of 11

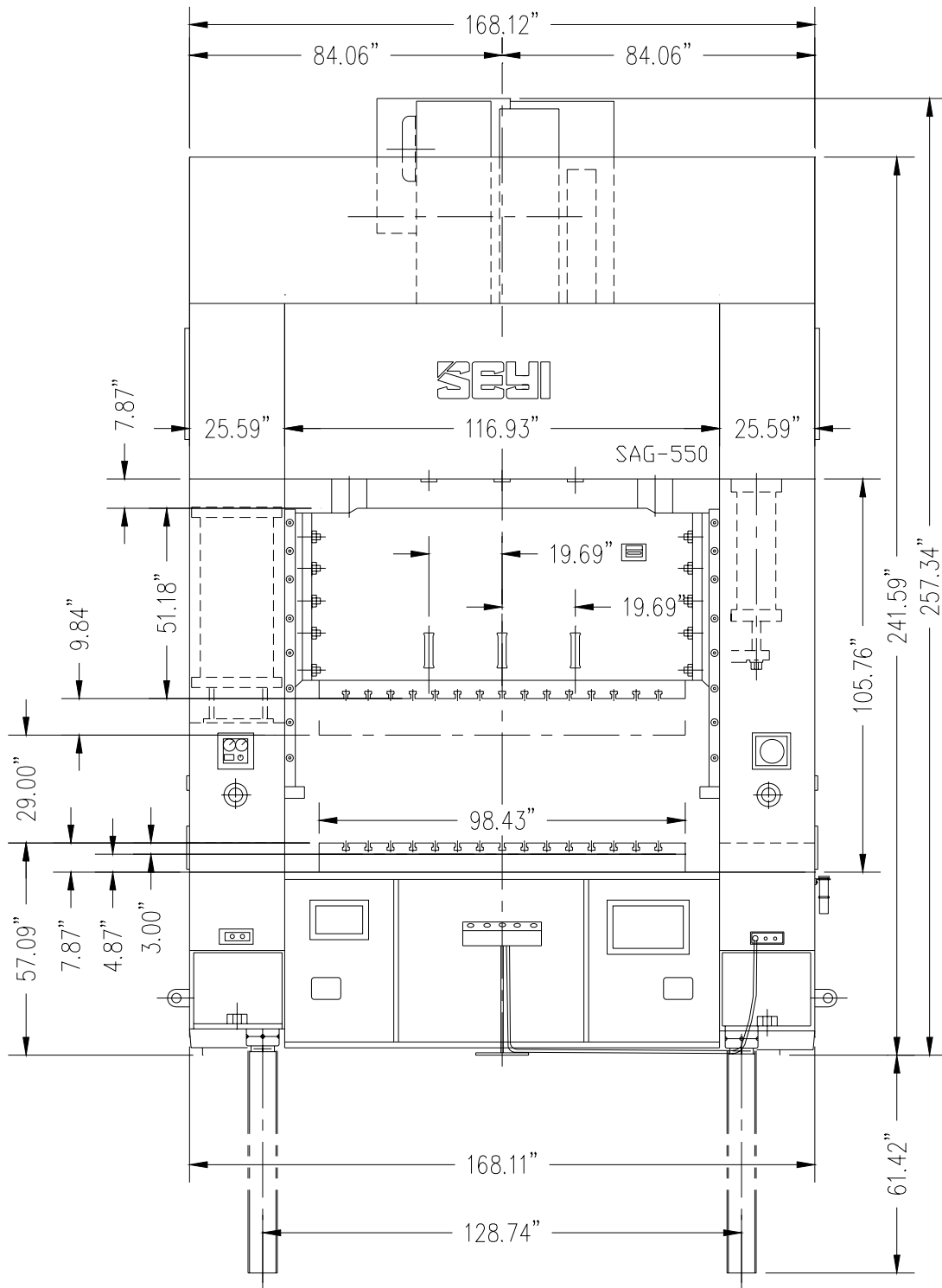

FRONT VIEW



SPARTANBURG STAINLESS PRODUCTS

PRESS LINE SPECIFICATION  
**PRESS 2700**  
(98" x 61" 550 Ton Single – Action)

Document No.:  
S02.?

Issue Date: 2/22/07  
Revision:3  
Page 7 of 11

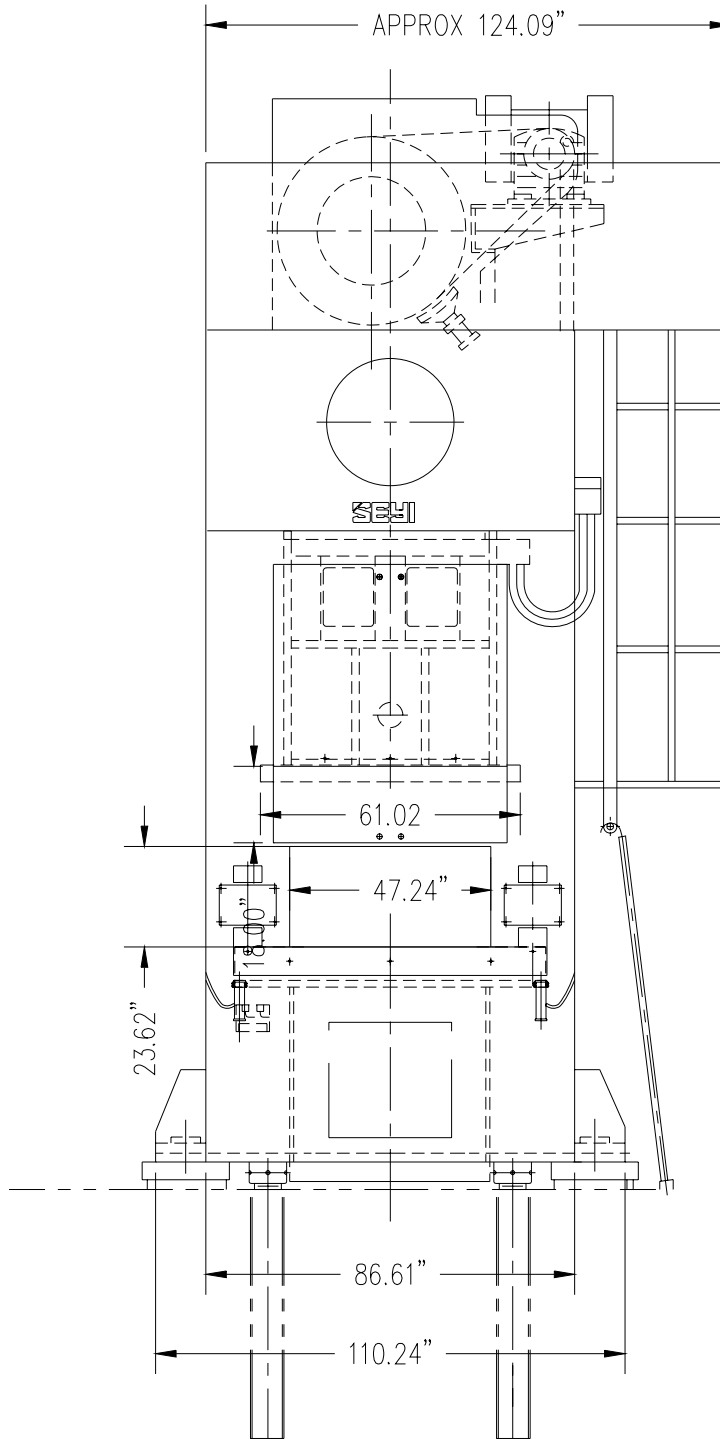

SIDE VIEW



SPARTANBURG STAINLESS PRODUCTS

PRESS LINE SPECIFICATION  
**PRESS 2700**  
(98" x 61" 550 Ton Single – Action)

Document No.:  
S02.?

Issue Date: 2/22/07  
Revision:3  
Page 8 of 11

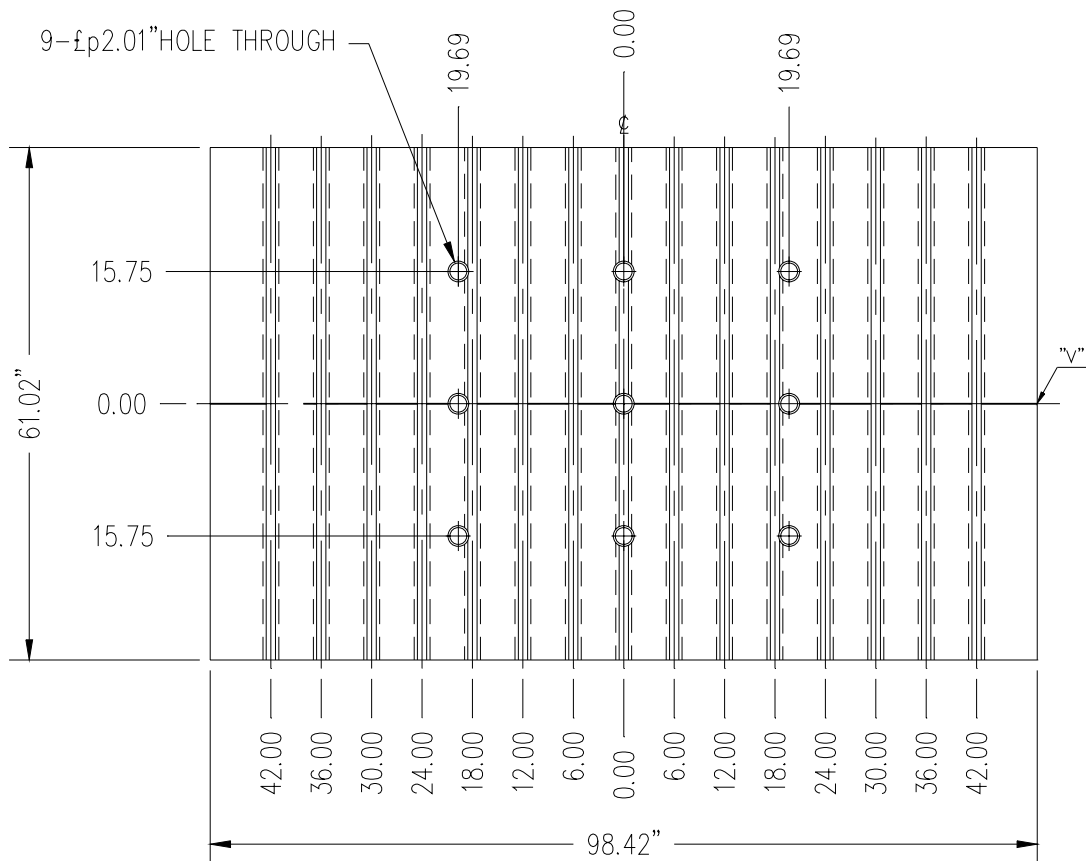
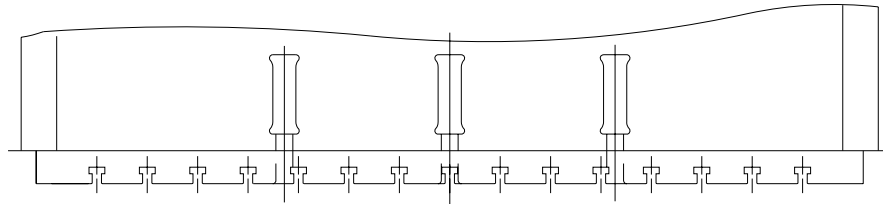

RAM DETAIL



SPARTANBURG STAINLESS PRODUCTS

PRESS LINE SPECIFICATION  
**PRESS 2700**  
 (98" x 61" 550 Ton Single – Action)

Document No.:  
 S02.?

Issue Date: 2/22/07  
 Revision:3  
 Page 9 of 11

NOTE:  
 -HATCHED AREAS ARE SCRAP EXIT THROUGH BOLSTER.  
 -DIE LOCATORS 1 & 9 DO NOT EXIST ON THE P2700 QDC PLATES

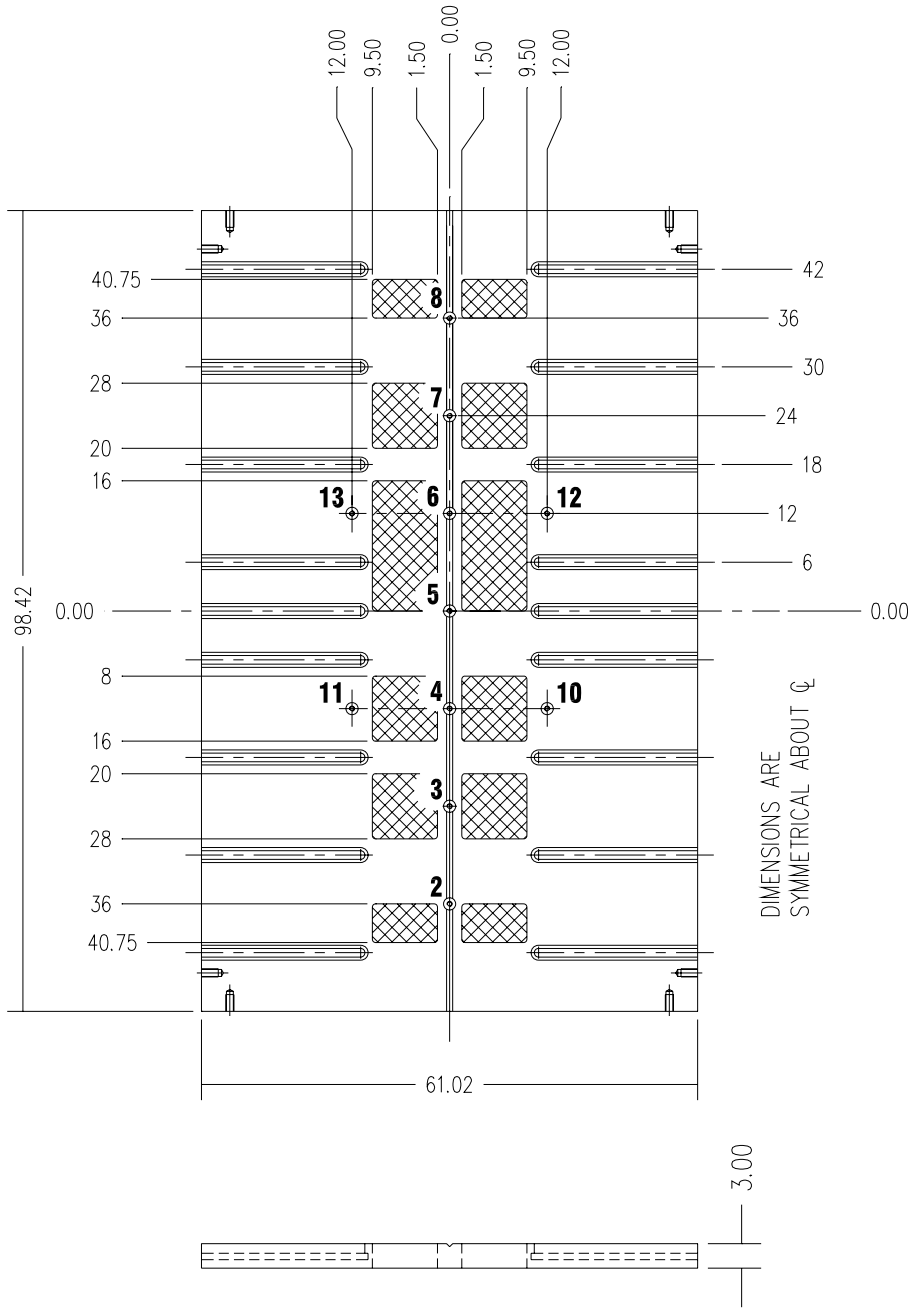

FRONT

FLOW

QDC PLATE  
 (DIE LOCATOR PIN LOCATIONS)  
 (SCRAP EXIT LOCATIONS)



SPARTANBURG STAINLESS PRODUCTS

Document No.:  
S02.?

PRESS LINE SPECIFICATION

**PRESS 2700**

(98" x 61" 550 Ton Single - Action)

Issue Date: 2/22/07

Revision:3

Page 10 of 11

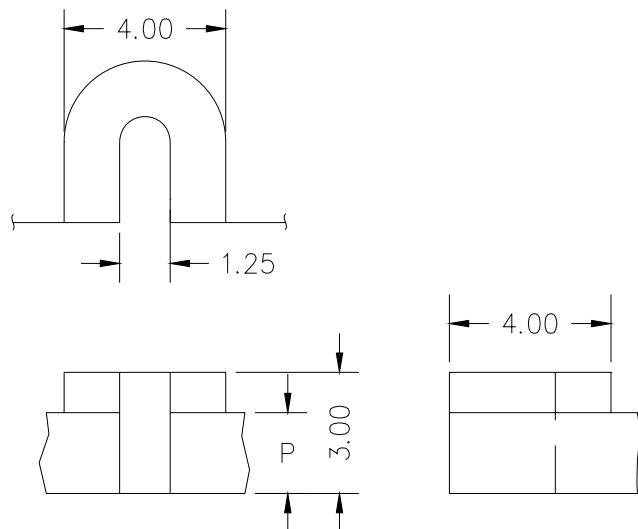
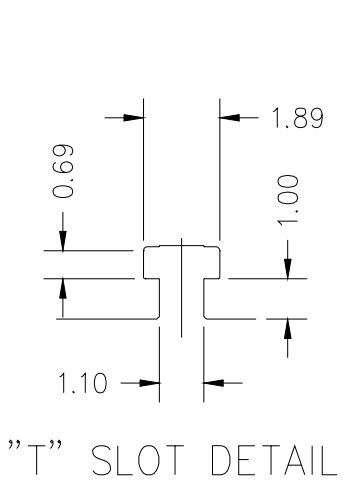
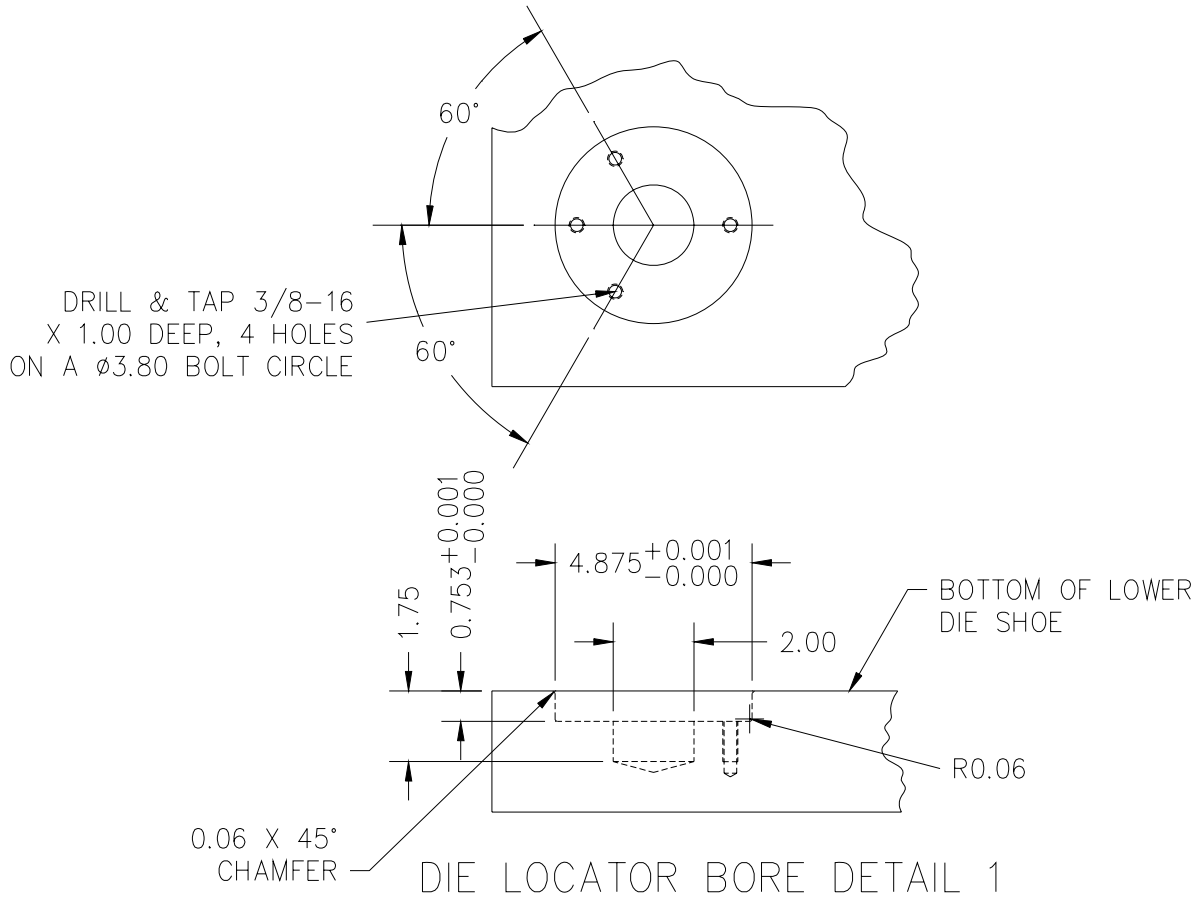



SPARTANBURG STAINLESS PRODUCTS

PRESS LINE SPECIFICATION  
**PRESS 2700**  
(98" x 61" 550 Ton Single – Action)

Document No.:  
S02.?

Issue Date: 2/22/07  
Revision:3  
Page 11 of 11

