	SPARTANBURG STEEL PRODUCTS PRESS LINE SPECIFICATION 1600 PRESS LINE PRESS 2884 & 2885 Was 1602 & 1604 (144" x 84" 1000 Ton – Single Action)	Document No.: S02.012 Issue Date: 21-Apr-06 Revision: Page 2 of 9
---	---	---

PRESS INFORMATION

	Inner (Metric)	Outer (Metric)
Work Capacity	1000 Tons (908MT)	N/A
Ram Size L/R – F/B	144" – 84" (3657.6mm – 2133.6mm)	N/A
Ram Spacer Thickness	None	N/A
Length of Stroke	28" (711.2mm)	N/A
Slide Adjustment	14" (355.5mm)	N/A
Shut Height From Q.D.C. S.D.A.U.	58" (1473.2mm)	N/A
Target Die Height	46" (1168.4mm)	N/A
<i>(Measured from Q.D.C. Plate)</i>		
Bolster Size L/R – F/B	144" – 84" (3657.6mm – 2133.6mm)	
Bolster Thickness	11" (279.4mm)	
Rolling Bolster	None	
Carriage Thickness	N/A	
Bolster Spacer	None	
Bolster Spacer Thickness	N/A	
Positive Knockout	None	
Quick Die Change Sub-Plates	Yes	
Sub-Plate Thickness	3" (76.2mm)	
Cushions (Number)	None	
Tons Each	N/A	
Tons Total	N/A	
Stroke	N/A	
Quantity @ Size L/R – F/B	N/A	
Distance From Bolster To Drip Pots	33.5" (850.9mm)	
Distance Between Gibbs L/R	145.875" (3705.23mm)	
Strokes Per Minute	20 Continuous	

	<p>SPARTANBURG STEEL PRODUCTS PRESS LINE SPECIFICATION 1600 PRESS LINE PRESS 2884 & 2885 Was 1602 & 1604 (144" x 84" 1000 Ton – Single Action)</p>	<p>Document No.: S02.012</p> <p>Issue Date: 21-Apr-06 Revision: Page 3 of 9</p>
---	--	---

AUTOMATION DEVICES USED

LOADER

<p>Destacker / Rollcoater / Loader None</p> <p style="padding-left: 40px;">Max. Sheet Thickness N/A</p> <p style="padding-left: 40px;">Min. Sheet Thickness N/A</p> <p style="padding-left: 40px;">Max. Sheet Size L/R – F/B N/A</p> <p style="padding-left: 40px;">Min. Sheet Size L/R – F/B N/A</p> <p style="padding-left: 40px;">Max. Loader Pass Height N/A <i>(From Top Of Bolster)</i></p> <p style="padding-left: 40px;">Min. Loader Pass Height N/A <i>(From Top Of Bolster)</i></p> <p style="padding-left: 40px;">Max. Stack Height N/A <i>(Including Pallet)</i></p>
--

UNLOADER

- | |
|---|
| <ol style="list-style-type: none"> 1) The unloader of this press does not have the ability to manipulate the part in any way. 2) The parts must pass from one press to another without being re-oriented. |
|---|

	<p style="text-align: center;">SPARTANBURG STEEL PRODUCTS PRESS LINE SPECIFICATION 1600 PRESS LINE PRESS 2884 & 2885 Was 1602 & 1604 (144" x 84" 1000 Ton – Single Action)</p>	<p>Document No.: S02.012</p> <p>Issue Date: 21-Apr-06 Revision: Page 4 of 9</p>
---	---	---

PRESS INFORMATION GENERAL

Comments:

- 1) The rams of 2884 & 2885 have 1" T-slots. Therefore the clamp slots will need to be wide enough to accommodate the T-bolts.



SPARTANBURG STEEL PRODUCTS
PRESS LINE SPECIFICATION
1600 PRESS LINE
PRESS 2884 & 2885
Was 1602 & 1604
(144" x 84" 1000 Ton – Single Action)

Document No.:
S02.012
Issue Date: 21-Apr-06
Revision:
Page 5 of 9

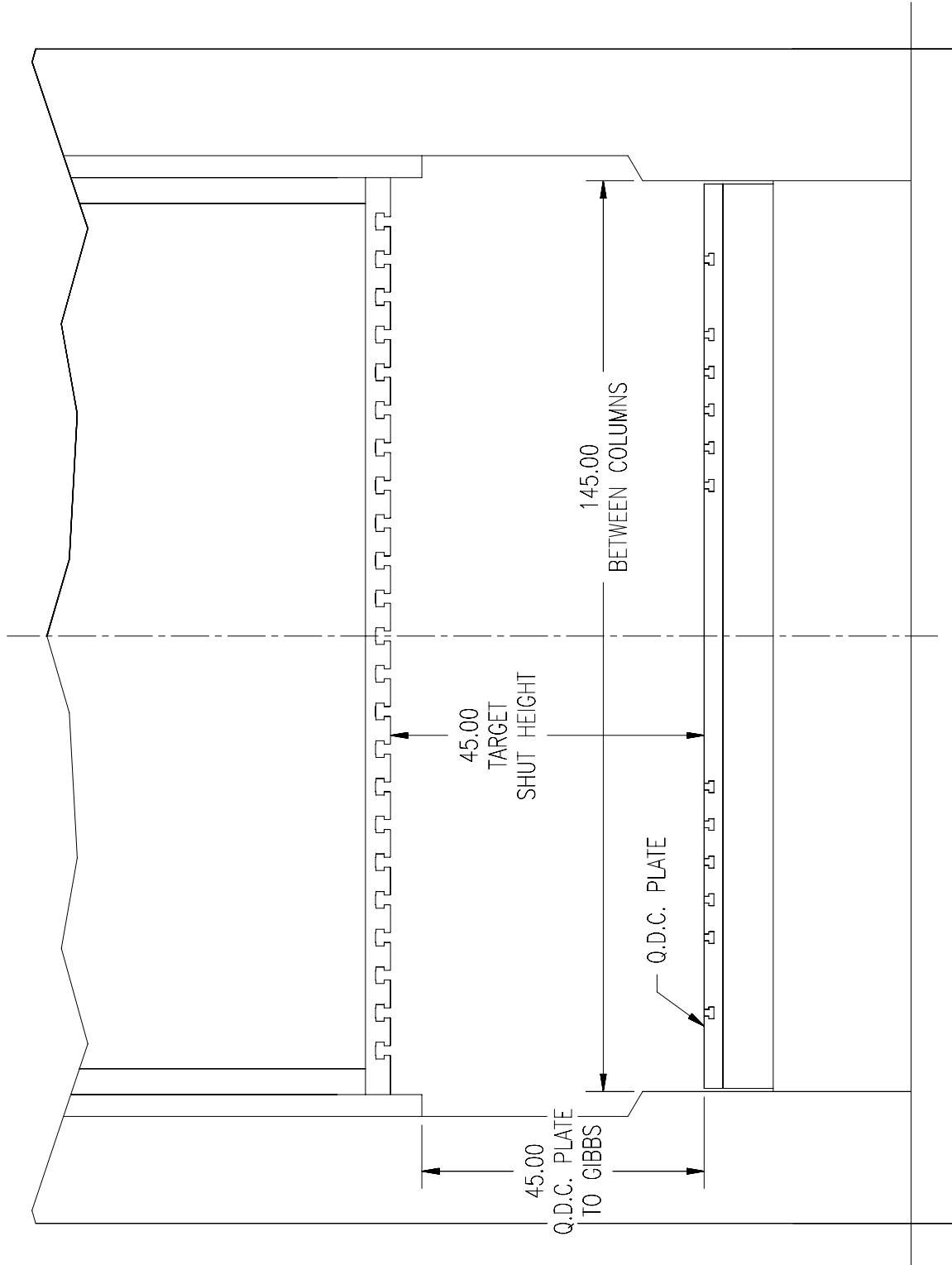



SPARTANBURG STEEL PRODUCTS
PRESS LINE SPECIFICATION
1600 PRESS LINE
PRESS 2884 & 2885
Was 1602 & 1604
(144" x 84" 1000 Ton – Single Action)

Document No.:
S02.012
Issue Date: 21-Apr-06
Revision:
Page 6 of 9

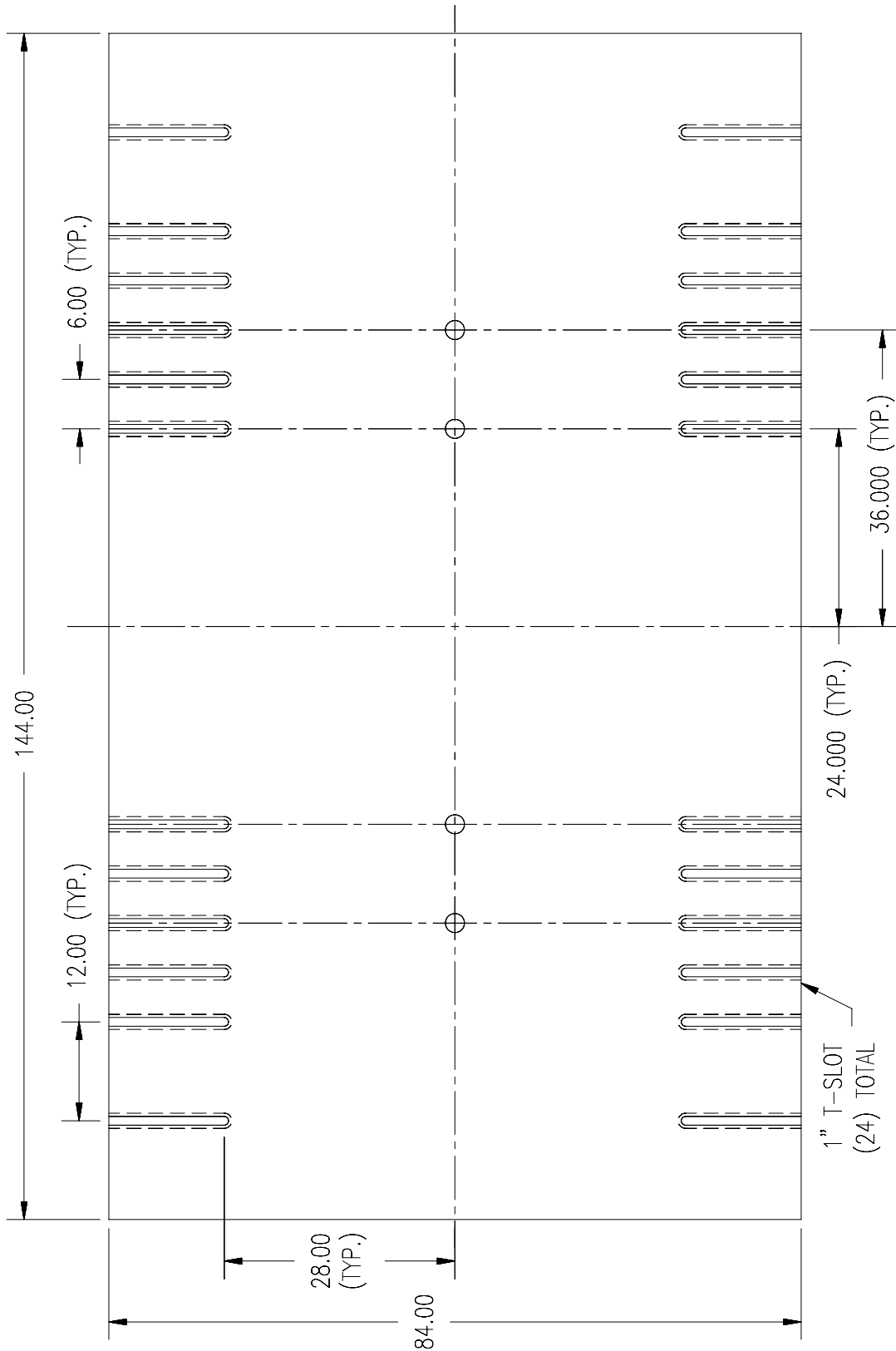

FRONT OF PRESS



SPARTANBURG STEEL PRODUCTS
PRESS LINE SPECIFICATION
1600 PRESS LINE
PRESS 2884 & 2885
Was 1602 & 1604
(144" x 84" 1000 Ton – Single Action)

Document No.:
S02.012

Issue Date: 21-Apr-06
Revision:
Page 7 of 9

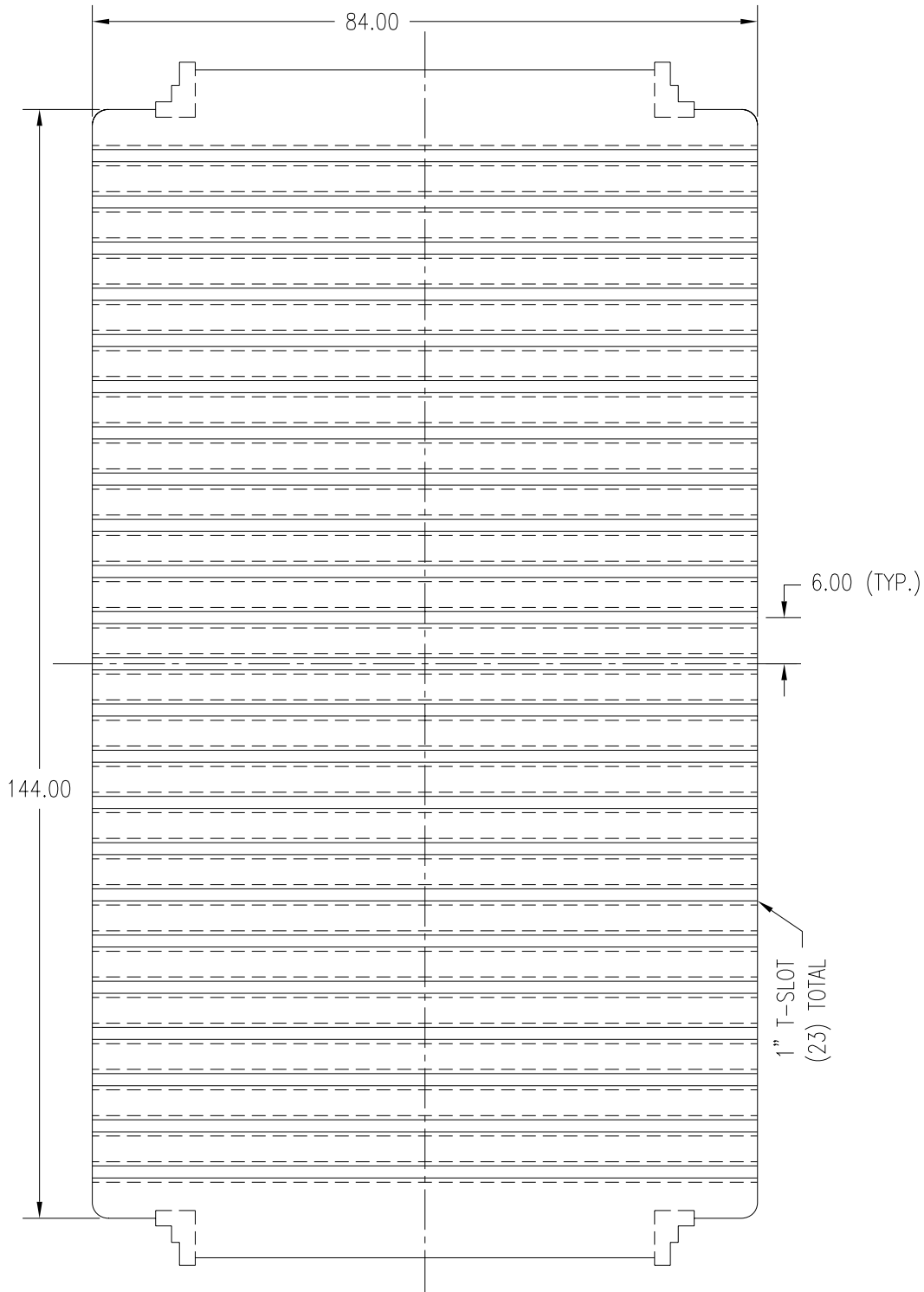

Q.D.C. PLATE



SPARTANBURG STEEL PRODUCTS
PRESS LINE SPECIFICATION
1600 PRESS LINE
PRESS 2884 & 2885
Was 1602 & 1604
(144" x 84" 1000 Ton – Single Action)

Document No.:
S02.012
Issue Date: 21-Apr-06
Revision:
Page 8 of 9

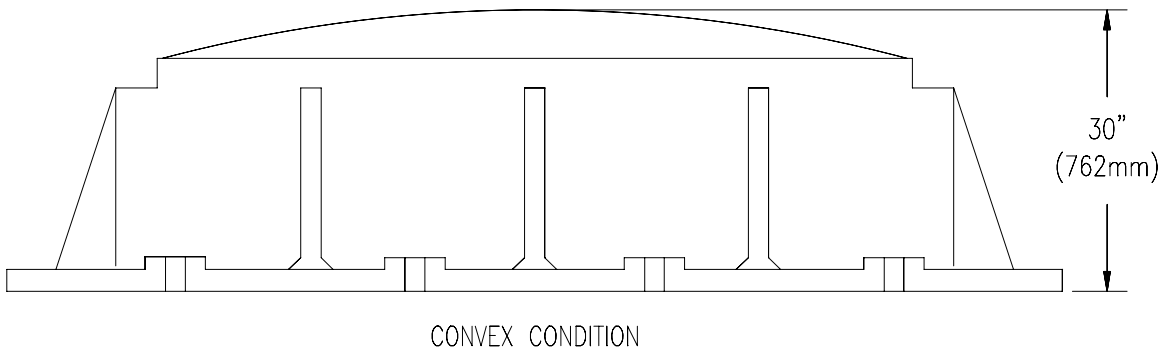
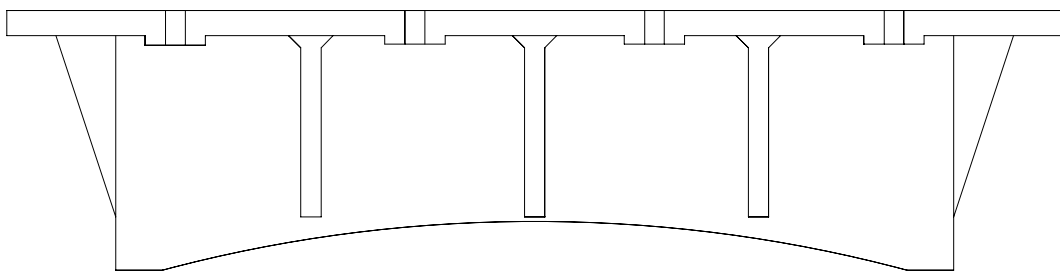
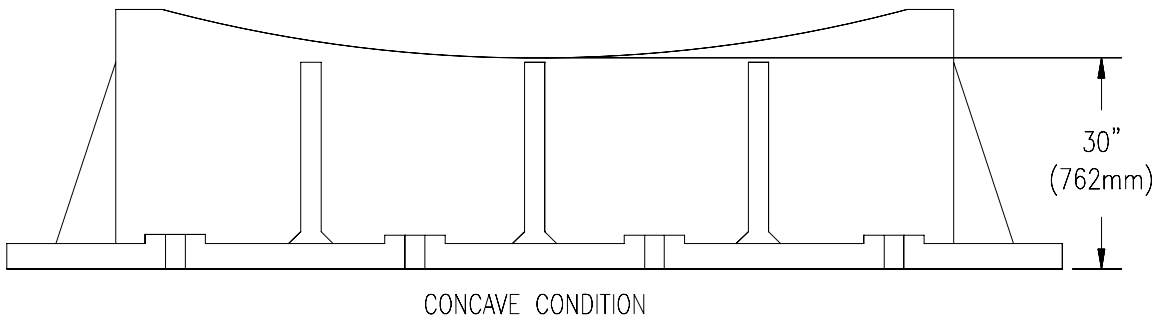
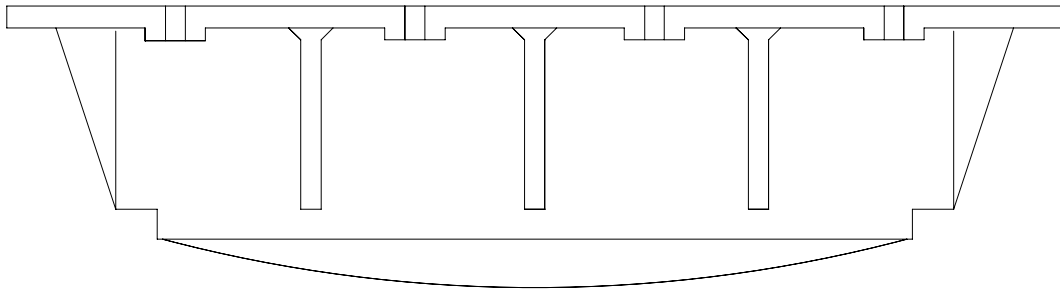

RAM FACE



SPARTANBURG STEEL PRODUCTS
PRESS LINE SPECIFICATION
1600 PRESS LINE
PRESS 2884 & 2885
Was 1602 & 1604
(144" x 84" 1000 Ton – Single Action)

Document No.:
S02.012
Issue Date: 21-Apr-06
Revision:
Page 9 of 9

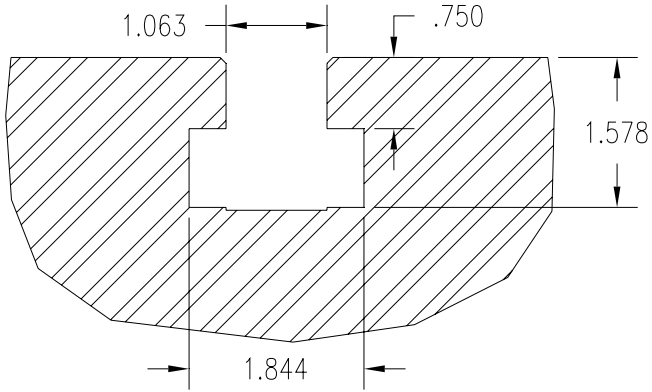

SECTION OF
Q.D.C. T-SLOT

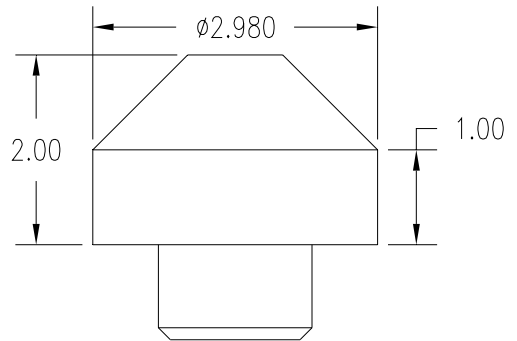

DETAIL OF DIE
LOCATOR PIN

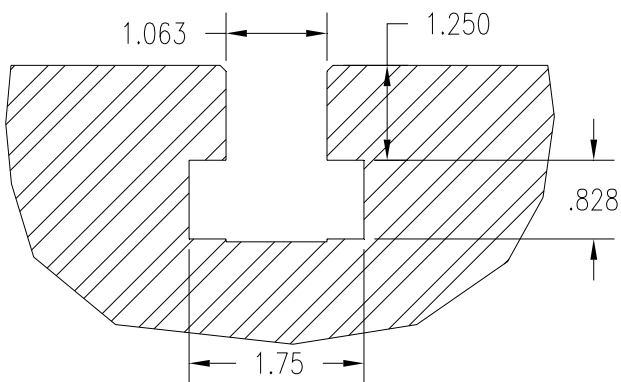

SECTION OF
RAM T-SLOT

SECTIONS & DETAILS